

1. Turn on APP, and then connect the machine by bluetooth

Please enter ' settings' -----' machine data'-----

A: When 2m2 tank=2, PCB=113, Structure=104?
Enter" update'----- click ' 2021061101' to update

B: When 2m2tank=0, PCB=111, Struction=104?
Enter' update'----- click' 2 ' to update -----waiting to finish
Restart the machine and APP
Connect the machine by bluetooth ----- enter' update'
----- click '2021061101'--- wait till finish

C: When 2m2tank= ?, PCB=112, Struction=104?
(1) Enter ' settings' ---- as below picture

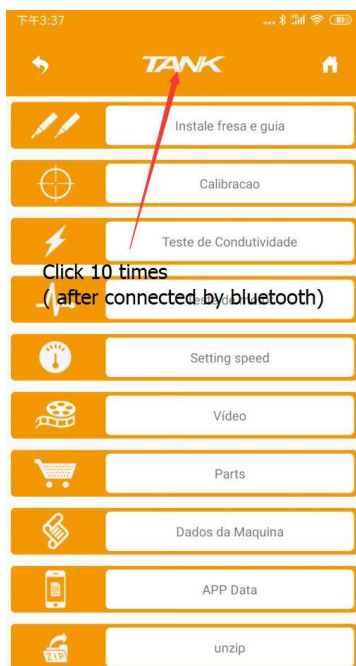

Click till machine sound

(2)

Restart the machine and APP
Connect the machine by bluetooth
Enter'setting'----- as below picture

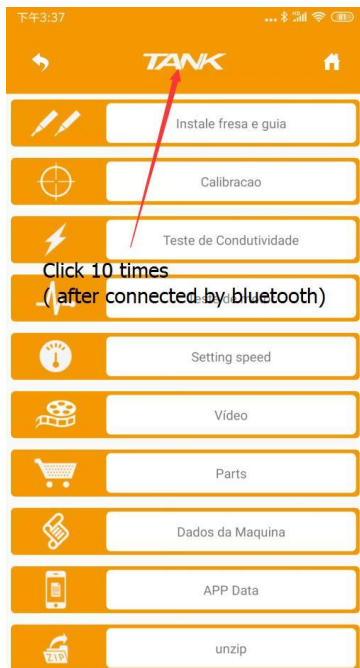

Click till machine sound

Restart the machine and App

Connect the machine by bluetooth

Enter 'Settings' ----- 'Machine data'----- check If it is 'PCB=111, structure = 104'.